

# OFFICIAL IDENTIFICATION

## CATTLE, YAK, AND BISON



### What are forms of official identification (ID)?

#### 1. Official eartag that is visually and electronically readable

Official electronic ID tags must contain:

- “840” as the first 3 numbers
- US shield
- Able to be read by an electronic reader

#### 2. Group or Lot ID (GIN)

#### 3. Breed registry tattoos and breed registration certificate\*

#### 4. Registered brand and an official brand inspection certificate\*

**\*Must be agreed upon by the state of origin and state of destination\***

Note: USDA metal NUES tags placed **PRIOR** to November 5th, 2024 **ARE** considered official ID.

*The yellow Wyoming Bangs OCV tag is NOT official ID.*

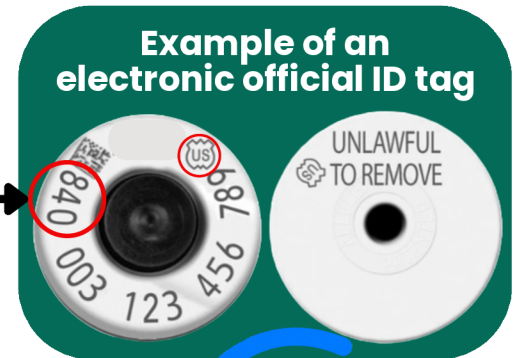

### What classes of cattle, yak, and bison require official ID?

#### 1. For **INTERSTATE** movement, the classes of cattle, yak, and bison listed below require official ID:

- **Sexually intact cattle, yak, and bison** that are **18 months of age or older**
  - Examples:
    - Breeding cows
    - Bred heifers
    - Bulls over 18 months of age
- **Dairy cattle** of any age
- **Rodeo cattle, yak, and bison** of any age
- **Show/exhibition cattle, yak, and bison** of any age

*Destination states may have more stringent rules for official ID.*

#### 2. Cattle, yak, and bison **staying in Wyoming** that require official ID:

- Cattle, yak, and bison that require regulatory testing, including brucellosis and tuberculosis testing
- Cattle, yak, and bison under commuter permits in Wyoming

### Situations when cattle, yak and bison require official ID

- Cows or bulls sold out of state for breeding purposes.
- Cows and heifers undergoing testing for brucellosis.
- Show/exhibition/rodeo cattle, yak, and bison participating in out-of-state events.

### Situations when cattle, yak and bison DO NOT require official ID

- Steers going to a feedlot out of state.
- Cattle, yak, and bison going direct to slaughter with an approved backtag.
- Cattle, yak, and bison going directly to an approved tagging site.

# OFFICIAL IDENTIFICATION

## EXHIBITION ANIMALS



### What exhibition animals are required to have official identification (ID)?

- All exhibition animals imported into Wyoming, regardless of age
- All sheep and goats used for exhibition, regardless of age
- Exhibition animals attending events that require official ID

Visit the **WLSB** website for more info!



### What are the forms of official ID for each exhibition species?

#### Cattle, Bison, Yak

840 RFID tag with US shield

USDA metal NUES tag placed PRIOR to November 5th, 2024

#### Pigs

840 RFID tag with US shield

USDA metal NUES tag

PIN tag

#### Sheep, Goats

840 RFID tag with US shield

Scrapie tag with US shield

Flock ID tattoo in one ear and individual ID tattoo in one ear

Approved microchips with required tattoos

### Key points to remember

- Official ID should **NEVER** be removed
- Animals should only have **ONE** form of official ID
  - Cattle may have a metal NUES tag and an 840 RFID tag
- 900 series RFID tags are **NOT** official ID
- Use official ID in exhibition records
- **Follow additional exhibition-specific rules for ID**

Breed registry tattoo and registration certificate



\*Sheep and goats that have absent or injured ears may have the eartag attached to a durable neck strap/collar that can only be removed by cutting it